

# Available for Bareboat Charter

## 2000 H.P. PUSHBOATS

### SUBCHAPTER M

#### TIER 3

**NEW CONSTRUCTION: Proven Design**

**DELIVERY: Beginning 1<sup>st</sup> Quarter 2019**

LOA	78' 0"
Beam (molded)	34' 0"
Depth (molded)	10' 0"
Design Draft	8' 2"
Eye Level	29' 0"
Main Propulsion	2 – Cummins QSK38-MI TIER 3
Gears	2 – Twin Disc H65321 – 5:96-1
Generators	2 – 60 kW John Deere Gen Sets; 99 HP @ 1800 RPM 4045TFM85
S.S. Sound Propellers	73 x 58

Fernstrum Coolers; Simplex Shaft Seals; Carlisle and Finch 500 watt and 1000 watt zeon searchlights

FURUNO FAR – 2127 Radar; 3 – VHF Radios and full electronics package including Swing Meter, Sounder, Bridge Watch and more.

**Picture of Sister Vessel**



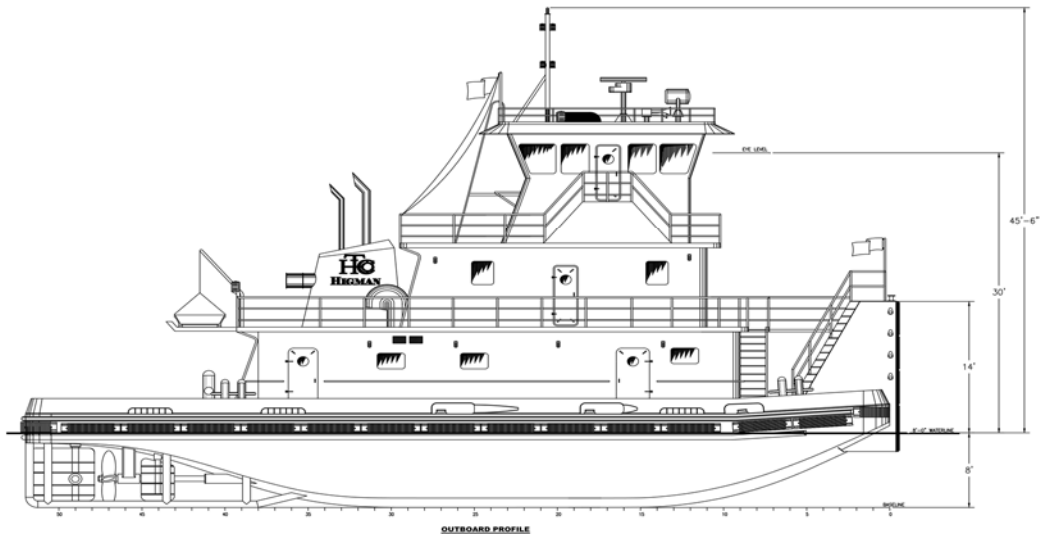

OUTBOARD PROFILE

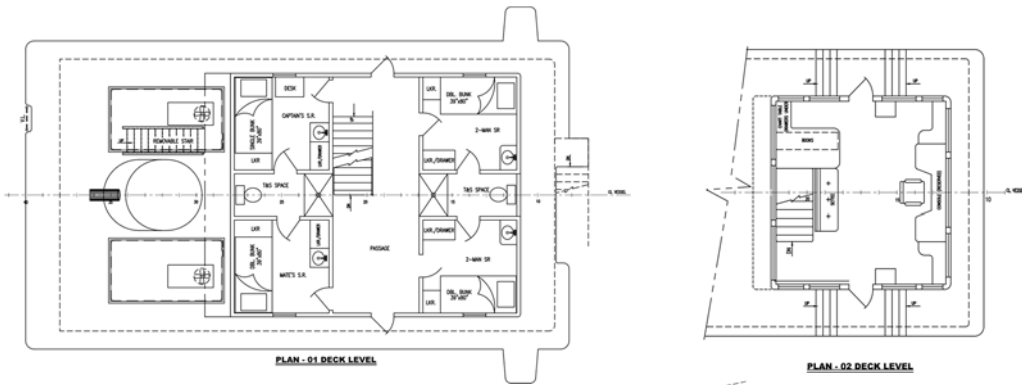

PLAN - 01 DECK LEVEL

PLAN - 02 DECK LEVEL

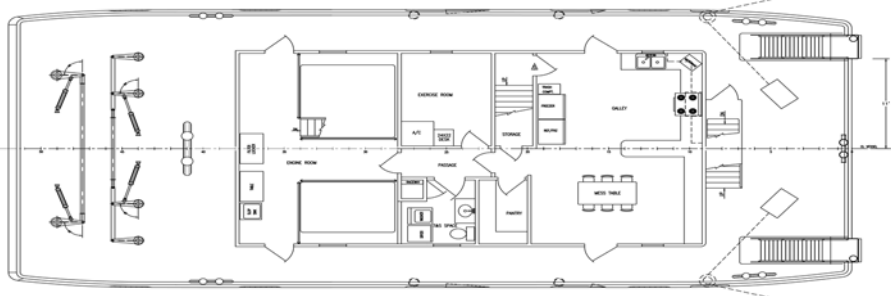

PLAN - MAIN DECK  
FINISHING NOT SHOWN, SEE BULKHEAD LISTS FOR DETAILS

ALL OTHER DRAWINGS IN THE INSTALLATION, INCLUDING ALL ELECTRICAL AND PIPING, SHALL BE A PART OF THIS PROJECT AND SHALL BE KEPT IN THE OFFICE OF THE ARCHITECT.

Copyright Protected - 2010

GENERAL ARRANGMENT

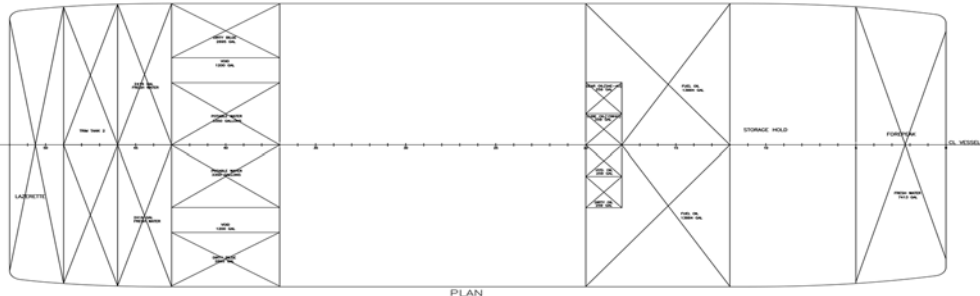

PLAN

FULLY LOADED  
 BOW DRAFT = 8'-2 1/2"  
 STERN DRAFT = 8'-2 1/2"  
 TRIM = 0"  
 20% FUEL AND FRESH WATER  
 BOW DRAFT = 6'-5"  
 STERN DRAFT = 7'-4"  
 TRIM = 11" AFT

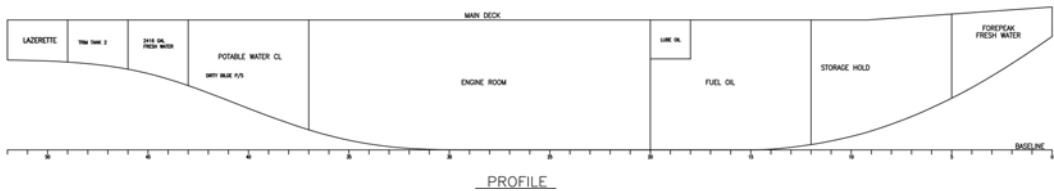

PROFILE